



# JURA

## El Galala

### Ain Sokhna

HAPPINESS COMES IN WAVES

2 0 2 0



# New Jersey

Investing in Egypt with lots of self-owned projects.

It is one of the leading companies in the field of real estate development over the past years, the modern urban community.

New Jersey development overwhelming success in many construction and real estate marketing businesses, a pioneering company in the field of building and construction. It is one of the most famous in the entire Arab world and indeed all over the world & includes the best and most famous engineers in engineering design.

The highest quality of life by developing high-tech smart homes.







# JURA El Galala Ain Sokhna

HAPPINESS COMES IN WAVES

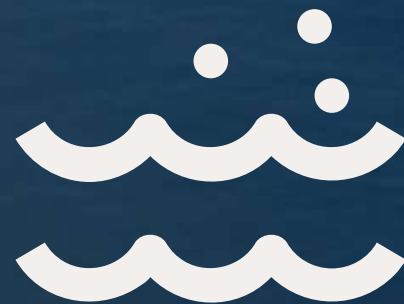

HAPPINESS COMES IN WAVE

An aerial photograph of ocean waves with white foam, set against a background of a brown, marbled texture. A semi-transparent white rectangular box is overlaid on the center of the image, containing the text 'HAPPINESS COMES IN WAVES'. In the top-left corner of the image, there are two white, stylized wave icons.

# HAPPINESS COMES IN WAVES



# GLOBALLY LOCATED... NATURALLY BEAUTIFUL

## GETTING THERE

### BY PLANE:

---

Only 4 hours away from Europe, West and Southern Africa, and all major cities of the Middle East and Asia

- Cairo International Airport
- Hurghada International Airport
- New Egyptian Capital City Airport

### BY LAND:

---

Cairo - Suez Highway	110 km
Katameya - Sokhna Highway	95 km
Kuraimat - Zaafarana Road	120 km
Hurghada - Zaafarana Road	320 km
Suez - Sokhna Road	40 km

### BY SEA:

---

- El Sokhna International Port
- Suez Canal



# JURA LOCATION MAP

Jura occupies a prime spot in Ain Sokhna next to the International Marina in the new Galala city.

With homes arranged over elevations ranging from 0 up to 20 meters above sea level, homeowners are guaranteed unobscured sea views.

Boasting a private sandy beach for relaxation and entertainment, Jura is an avant-garde development that captures the best of contemporary architecture to foster unique and intimate encounters with its surrounding elements.





SUEZ ROAD

NEW CAIRO

CAIRO-AIN SOKHNA ROAD

NEW CAPITAL

REGIONAL RING ROAD

AIN SOKHNA TOLL STATION

AIN SOKHNA

RED SEA

JURA

NEW GALALA ROAD

ZAAFARANA

HAPPINESS COMES IN WAVE

# Galala City

Considered as one of the largest Egyptian development projects, with a unique tourist-attractive location, virgin beaches and a high altitude that gives the city the climatic advantage of a temperature drop below sea level of 10 degrees.

Most importantly  
180-degree sea views,  
thanks to its innovative  
leveling technique.

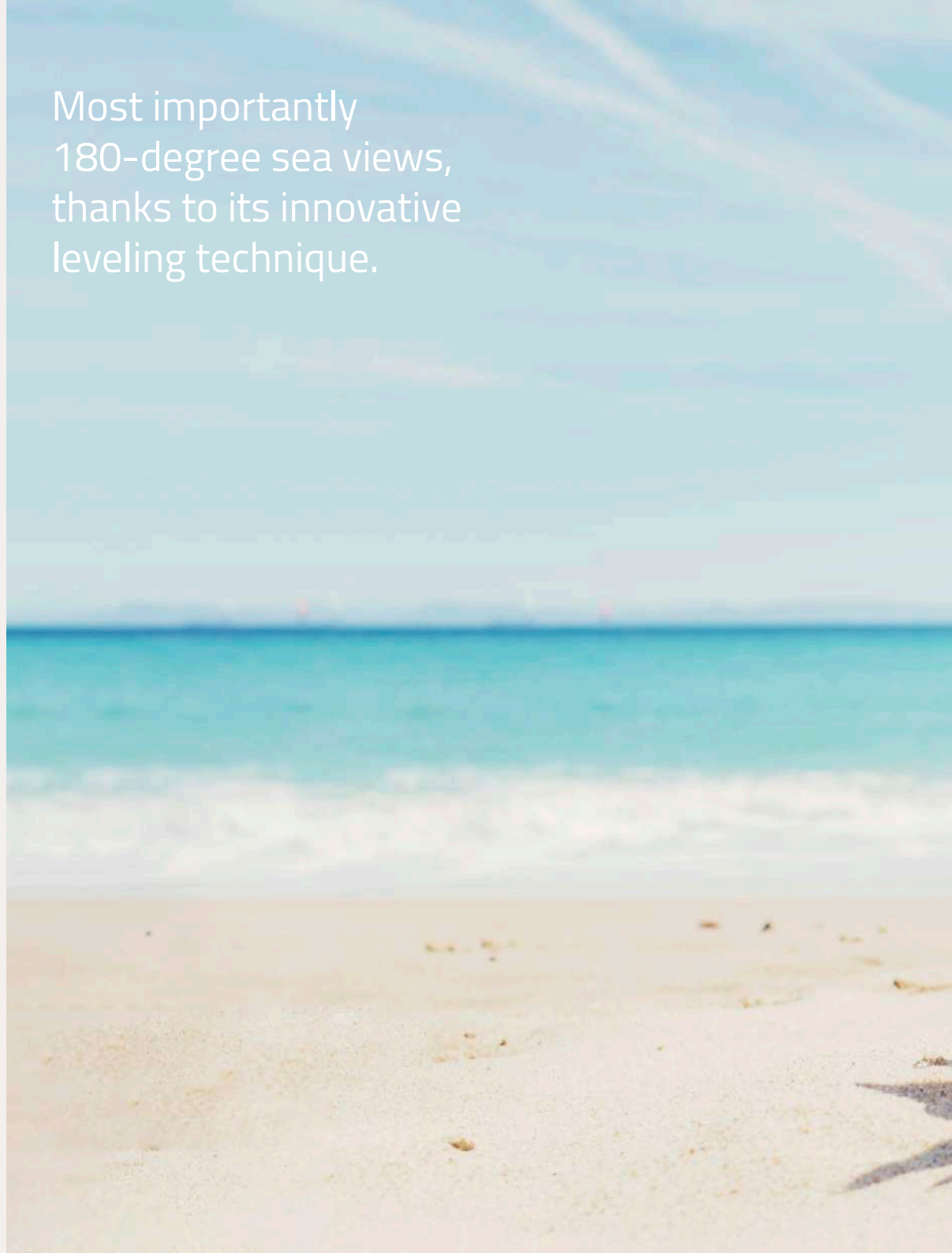



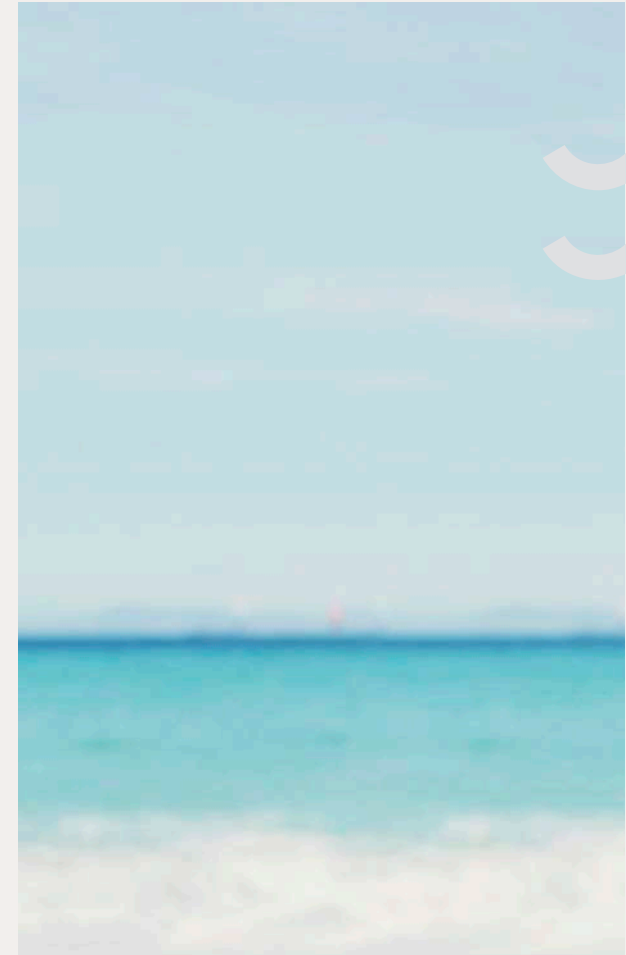

HAPPINESS COMES IN WAVE

It has already attracted investments of more than US\$ 100 million in the last two years. The City is located on the highest mountain plateau between Ain Sokhna and Zafarana and overlooks the Red Sea coast. It lies approximately 170 kilometers away from the Cairo International Airport and 50 kilometers away from Port Sokhna.

# Imagine living minutes

From a world-class international marina, offering 300 berths all fully equipped with the latest technology and top-class amenities to ensure yacht owners have quick and easy access to their boats to traverse the Red Sea in style.

Imagine no more, Jura invites you to dream with eyes wide open, offering ideal winds and direct access to the Galala Touristic Marina.

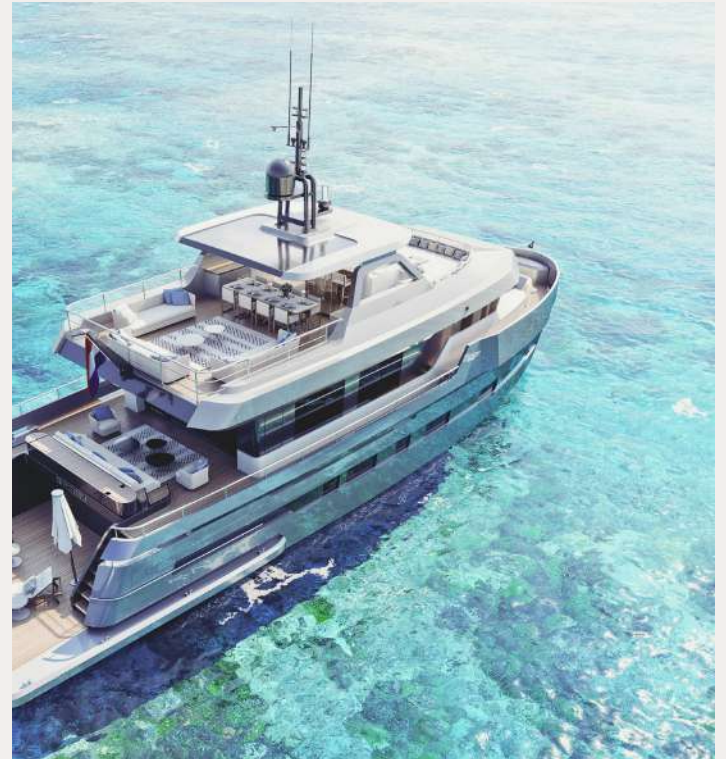



Jura is cleverly designed 0-20 meters above sea level to break down Sokhna's captivating beauty at zero ground level to introduce, gated communities seamlessly interconnected with ultra-modern bridge and quality roads- reflecting an aesthetic union of function and form.

The destination's core beauty lies in its prime location, opening onto infinite sea view and IL Galala's International Marina, allowing its +300 units to forge a direct, uninterrupted connection with nature, beaming with beauty in equal measure.







# JURA's Location

JURA's location is one of a kind where it's only 1 hour away from New Cairo and 40 minutes away from the new administrative capital, within less than one hour you will be on a piece of heaven

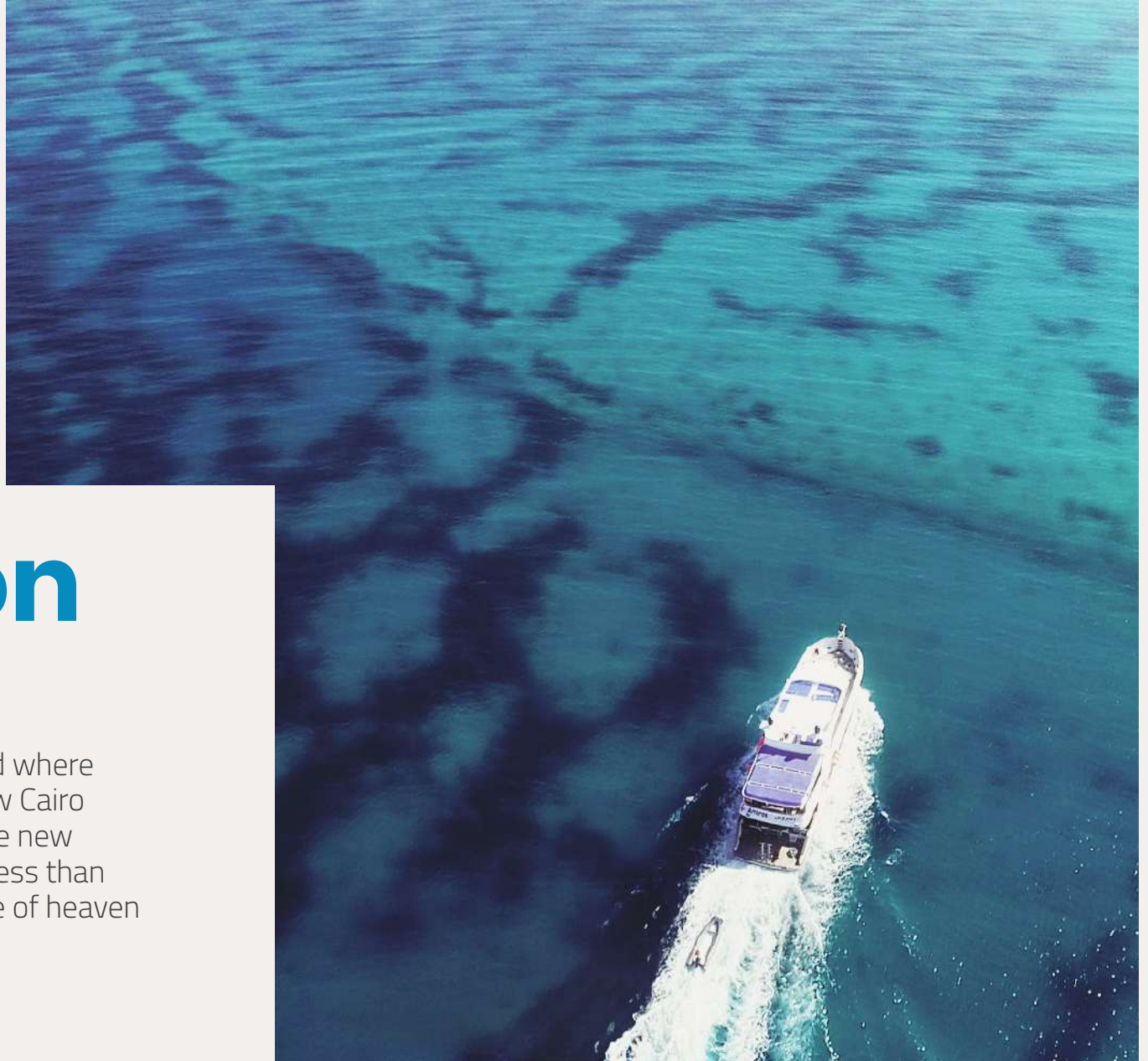



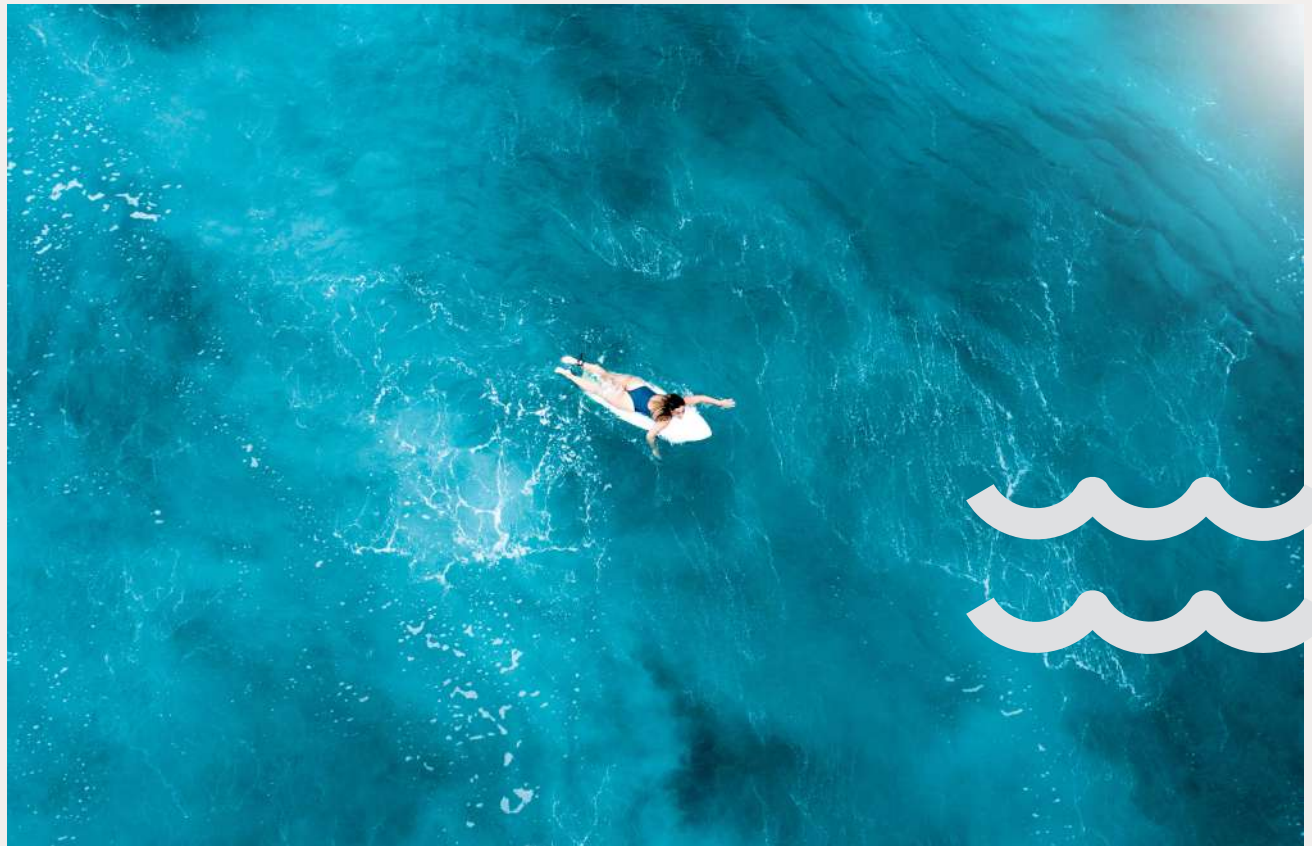

HAPPINESS COMES IN WAVE





# Boutique

Where luxury and beach life meet together serviced chalets are fully integrated to serve JURA's community.

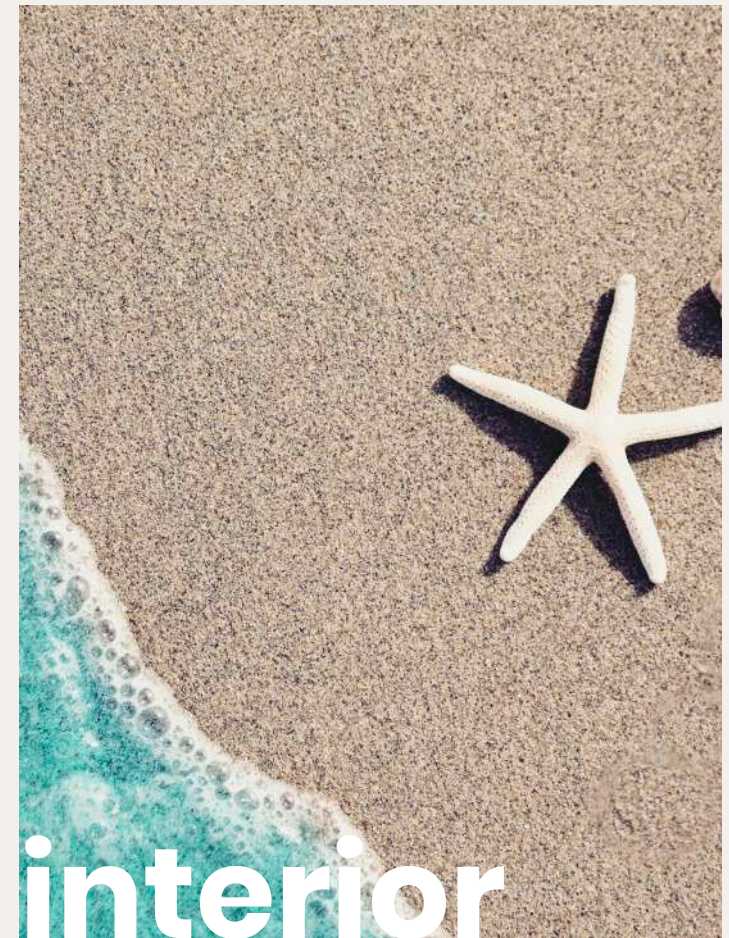

# interior design

All units are fully finished, furnished, and services making use of every inch.





# CITY WALK

A five minutes' walk that pours directly in all EL Galala city.







# 80 % Green landscape



Our constructions are plotted 20% and the remaining is well distributed for all of our facilities and services.

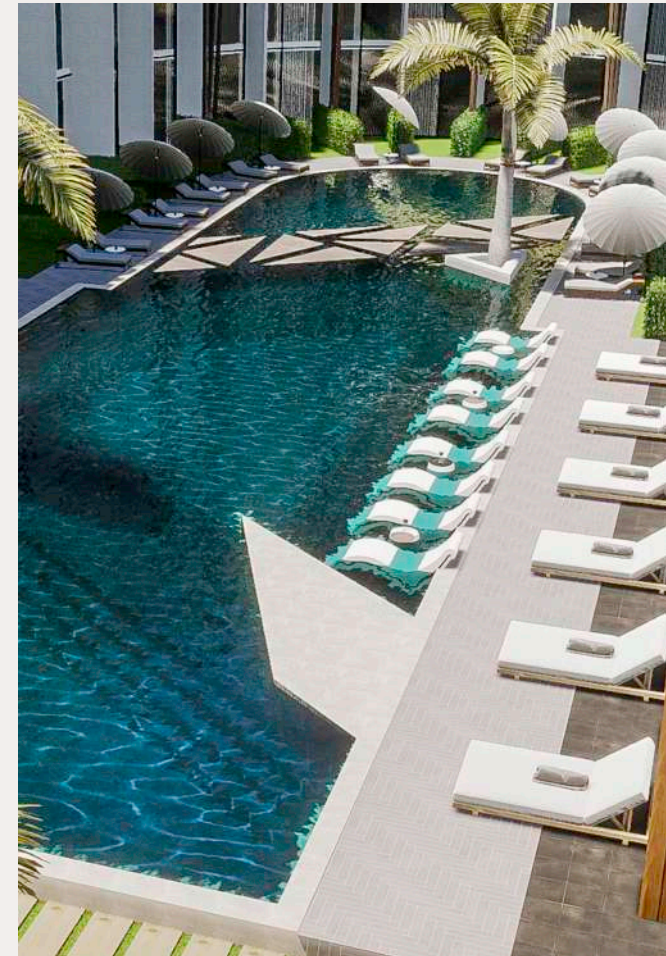







# FACILITIES

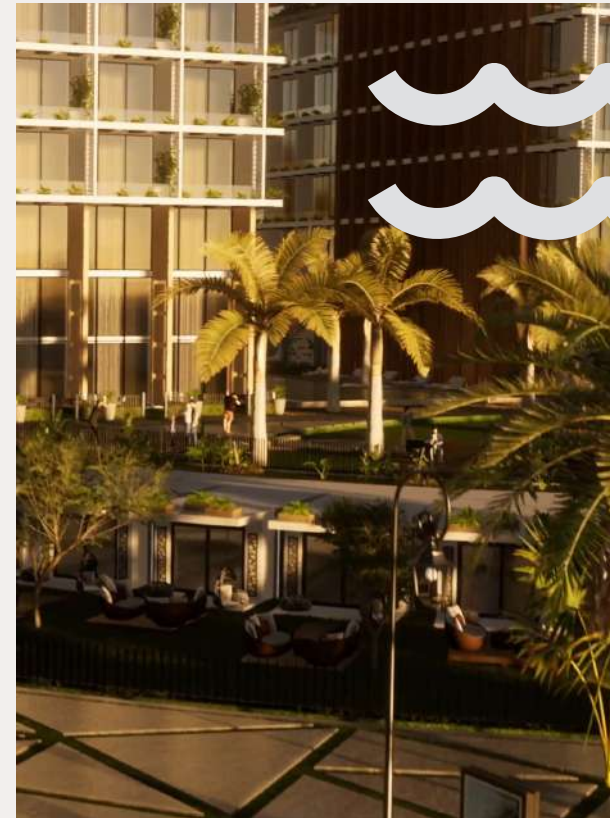

HAPPINESS COMES IN WAVE



# JURA

JURA | EL - GALALA AIN SOKHNA

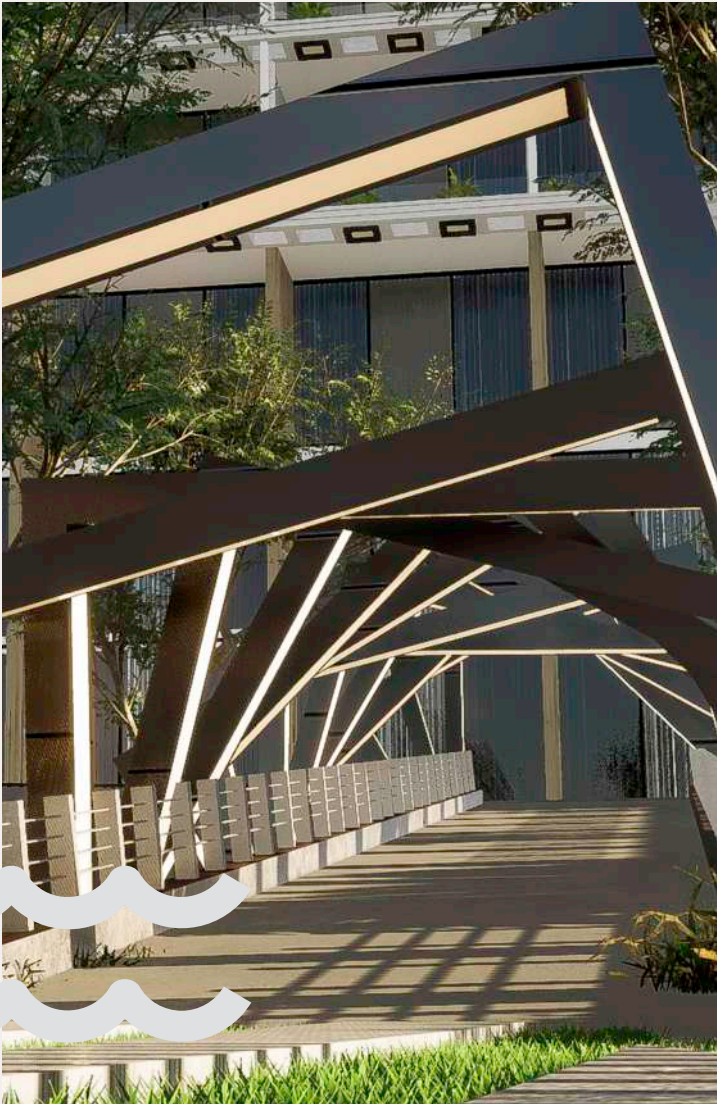





HAPPINESS COMES IN WAVE







# FINE DINING

JURA | EL-GALALA AIN SOKHNA







HAPPINESS COMES IN WAVE







# SWIMMING POOLS



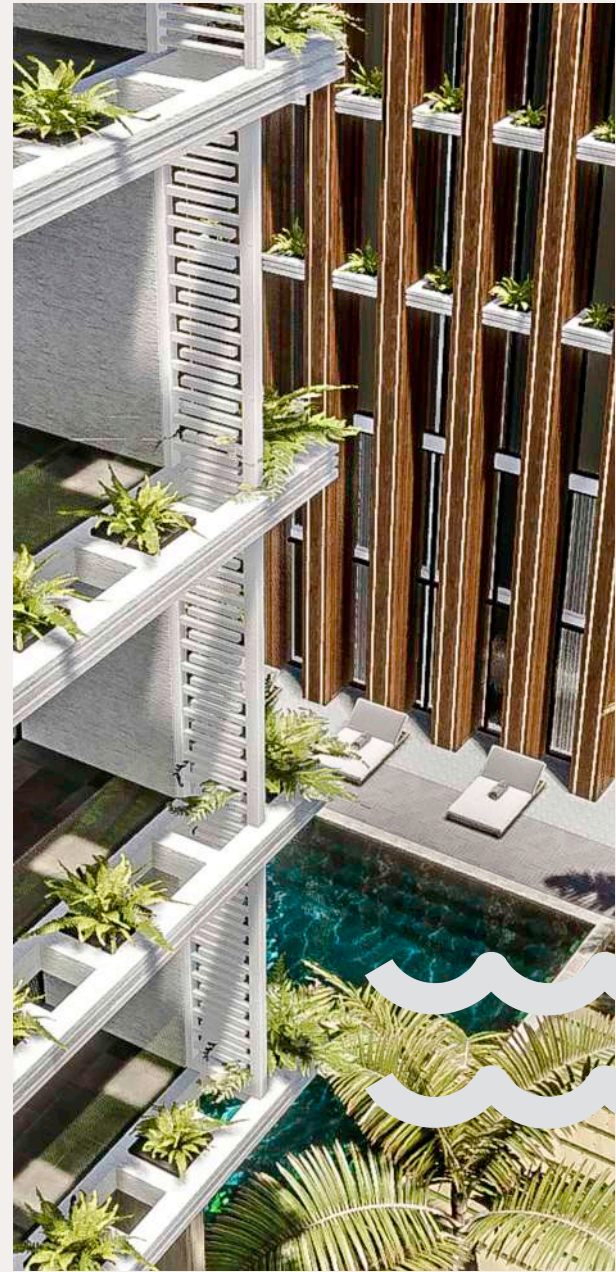

HAPPINESS COMES IN WAVE



# BEACH CLUB HOUSE







HAPPINESS COMES IN WAVE







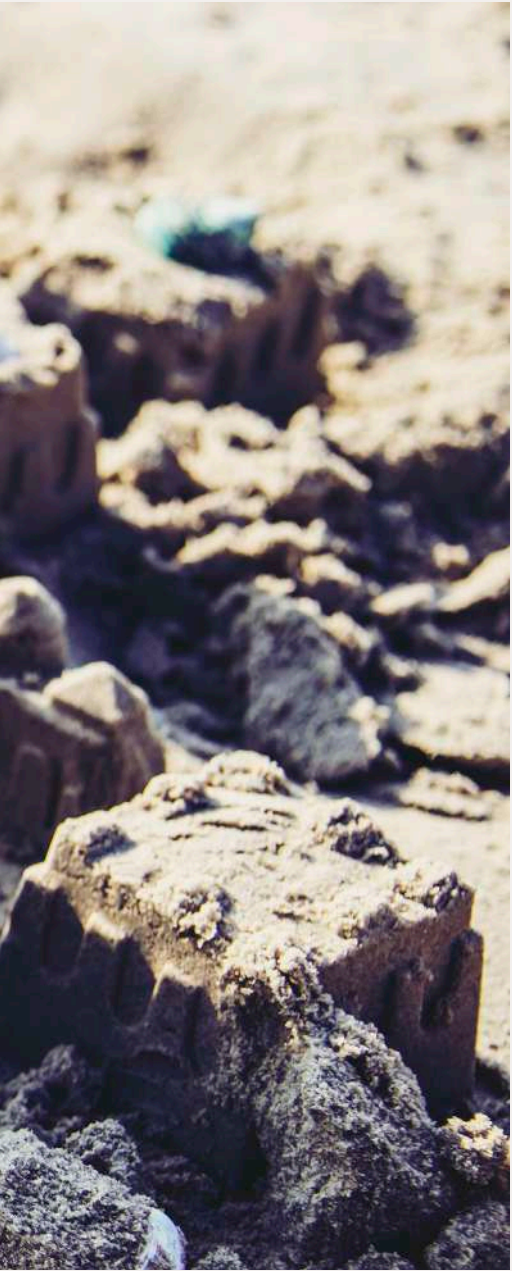

# KIDS AREA



HAPPINESS COMES IN WAVE





# ROOF RESTAURANT

JURA | EL-GALALA AIN SOKHNA







HAPPINESS COMES IN WAVE



# YACHT MARINE

JURA | EL - GALALA AIN SOKHNA







HAPPINESS COMES IN WAVE



# GOLF CAR APPLICATION

JURA | EL - GALALA AIN SOKHNA





# WATER JETS



HAPPINESS COMES IN WAVE



# JOGGING TRACK







HAPPINESS COMES IN WAVE



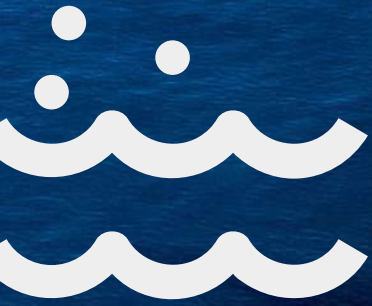

**Thank You.**  
Let's work together.

